



See Page 2 for General Notes.

© Not to be reproduced or distributed.

10020104789700

Description: A wood mantel with “cable fluted” columns, but otherwise simple styling, encloses the full depth of a heat circulating gas fireplace that is accented with a polished brass trim set. A ceramic tile surround and hearth is color coordinated with the wall and floor covering. A drywall enclosure above the mantel extends to the ceiling, like a traditional chimney breast, adding to the overall fireplace aesthetics.

Contact Info:

HotDesigns.com

Title: Fireplaces Design

Page No. 1 of 3

Design No. **100**

## General Notes:

This design is for illustrative and conceptional purposes. The specific details of its construction will depend on many factors such as the type of fireplace materials used, the particular manufacturer's installation instructions and applicable building codes. For example, the clearances to combustible materials used in the fireplace construction vary from fireplace to fireplace. Also, wood burning fireplaces (and a small number of gas fireplaces) require a non-combustible hearth. These are routine but important details that affect the safe construction of any fireplace. It is contemplated that some design modifications may be desired to suit personal preferences - use the Design Revisions section on page 3 to make comments. Also on page 3, is a grid for the customer to mark a layout of the area of the room where the fireplace would be installed to identify and locate electrical outlets, heating/cooling vents, windows etc. that could impact the proposed installation. It is in everyone's best interests to review these details with the local fireplace dealer from the beginning to avoid wasting time planning a fireplace that may otherwise be impractical or cost prohibitive due to the location of such household features.

Item #	Description
①	A drywall enclosure extends from the top of the mantel to the ceiling which conceals the gas fireplace vent pipe. The enclosure projects out from the wall which is typical of a traditional fireplace chimney breast and is painted off-white to visually set it apart from the wall behind - but it is common for it to be painted the same as the wall. This is a matter of personal preference. Of course, there are numerous gas fireplaces available as rear vent models that would not require this enclosure at all - but this feature does contribute to the overall look of this fireplace design. The width of the enclosure can vary, but it is common for the width to be set so there is the same amount of mantel shelf projection on each side of the enclosure as there is at the front. These dimensions could be affected by the vent pipe location and its clearances to combustibles. It is advisable to review these details before deciding on a particular fireplace model.
②	A cabinet style mantel encloses the pre-fabricated fireplace. The wood mantel is stained, features "cable fluted" columns but otherwise has simple yet elegant styling. A low profile shelf has a modest outward projection beyond the top and side edges of the mantel body. However, virtually any style of cabinet mantel to suit individual preferences could be substituted to create a similar look.
③	A hefty wood border, stained the same as the mantel, frames the sides and front edges of the hearth which is made with ceramic tiles. The tiles are laid on top of a built up base to be flush with the top surface of the wood border. Note: The fireplace must be raised accordingly at the time of installation to prevent the elevated hearth surface blocking any fireplace vent openings or access to gas controls etc.
④	The same ceramic tile used on the hearth surrounds the fireplace unit. The tile compliments the floor and wall colors. Alternatively, a surround that compliments the wood mantel, or a black surround that ties in with the fireplace unit, or an off-white surround that compliments the vent enclosure above the mantel, could also be considered.
⑤	A heat circulating, prefabricated gas fireplace with a prominent polished brass trim set that overlaps the ceramic tile surround. This gas fireplace has no hearth requirement - the one provided is for aesthetic reasons. Most other types of built-in fireplaces could be used with this fireplace design with the appropriate modifications to meet all applicable installation requirements.

Contact Info:

HotDesigns.com

Title:

General Notes

Page No.

2 of 3

Design No.

**100**

Design Revisions: ( State any desired modifications - additions / deletions / substitutions )

Room Floor Plan: Mark location of electrical outlets, heating vents, windows etc. within 3' of proposed fireplace - see attached sample.

Room type & floor level: \_\_\_\_\_ House description: \_\_\_\_\_

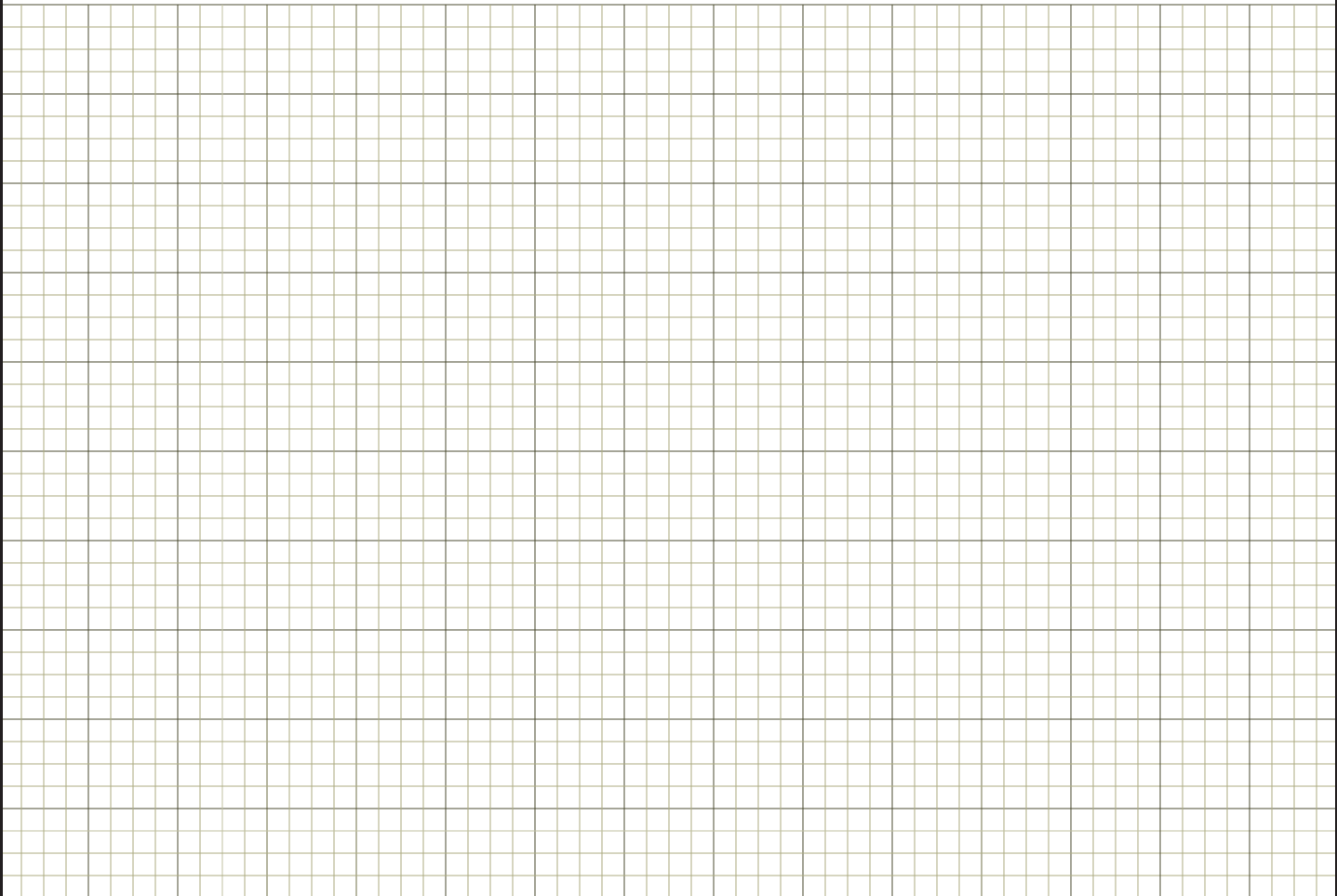

Scale: Major divisions = 1' (300mm)

Contact Info:

HotDesigns.com

Title:

Fireplace Plan

Page No.

3 of 3

Design No.

**100**

Design Revisions: ( State any desired modifications - additions / deletions / substitutions )

-Substitute the mantel for another one with simple styling but with a thicker shelf that preferably has a dentil molding and darker wood stain

-Keep hearth as close to floor level as possible - customer will supply tile

-Paint overmantel enclosure to match wall color

-Review other styles of brass trim or decorative fronts

Room Floor Plan: Mark location of electrical outlets, heating vents, windows etc. within 3' of proposed fireplace - see attached sample.

Room type & floor level: Family room - 1st floor House description: 2 storey- wood frame

SAMPLE

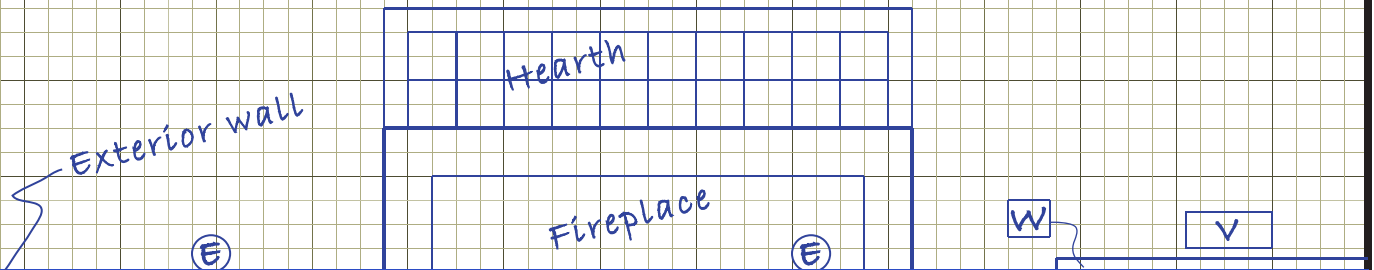

Scale: Major divisions = 1' (300mm)

ⓔ - Electrical outlet - wall mounted

Ⓜ - Window

Ⓥ - Floor vent

Contact Info: Bob or Debbie 765-4321

HotDesigns.com

Title: Fireplace Plan

Page No. 3 of 3

Design No. **100**